

Notes

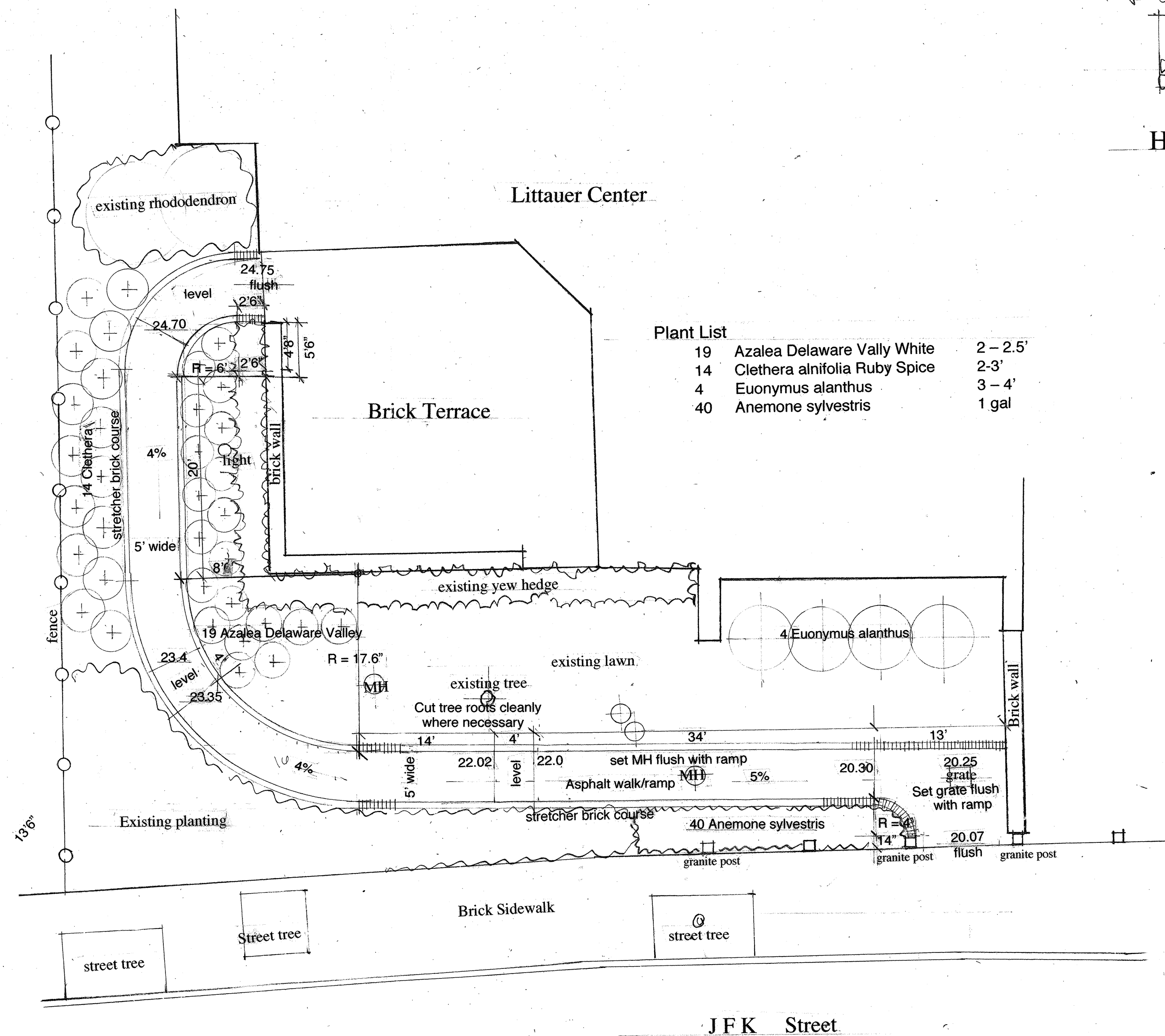

Littauer Center Handicap Ramp

Total Run of ramp: elevation 20.07 to 245.75 (56 1/4')

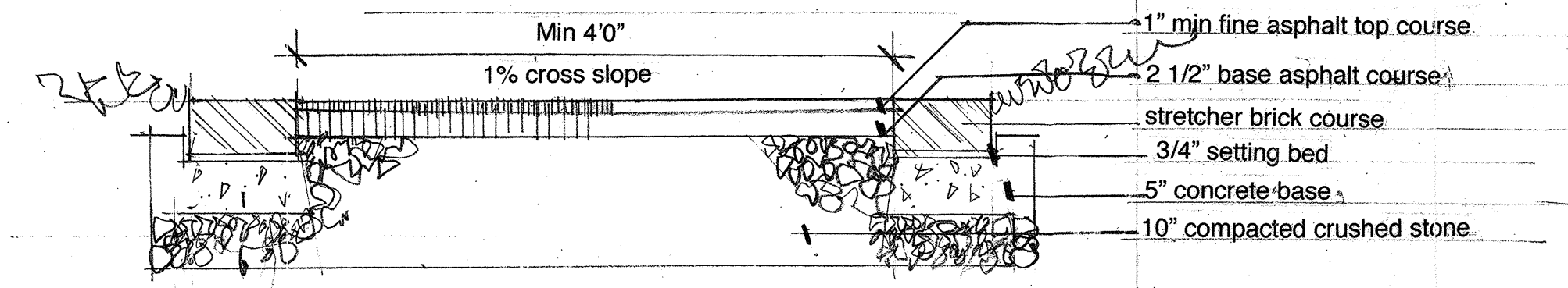

Handicap Ramp scale 1" = 1' 0"

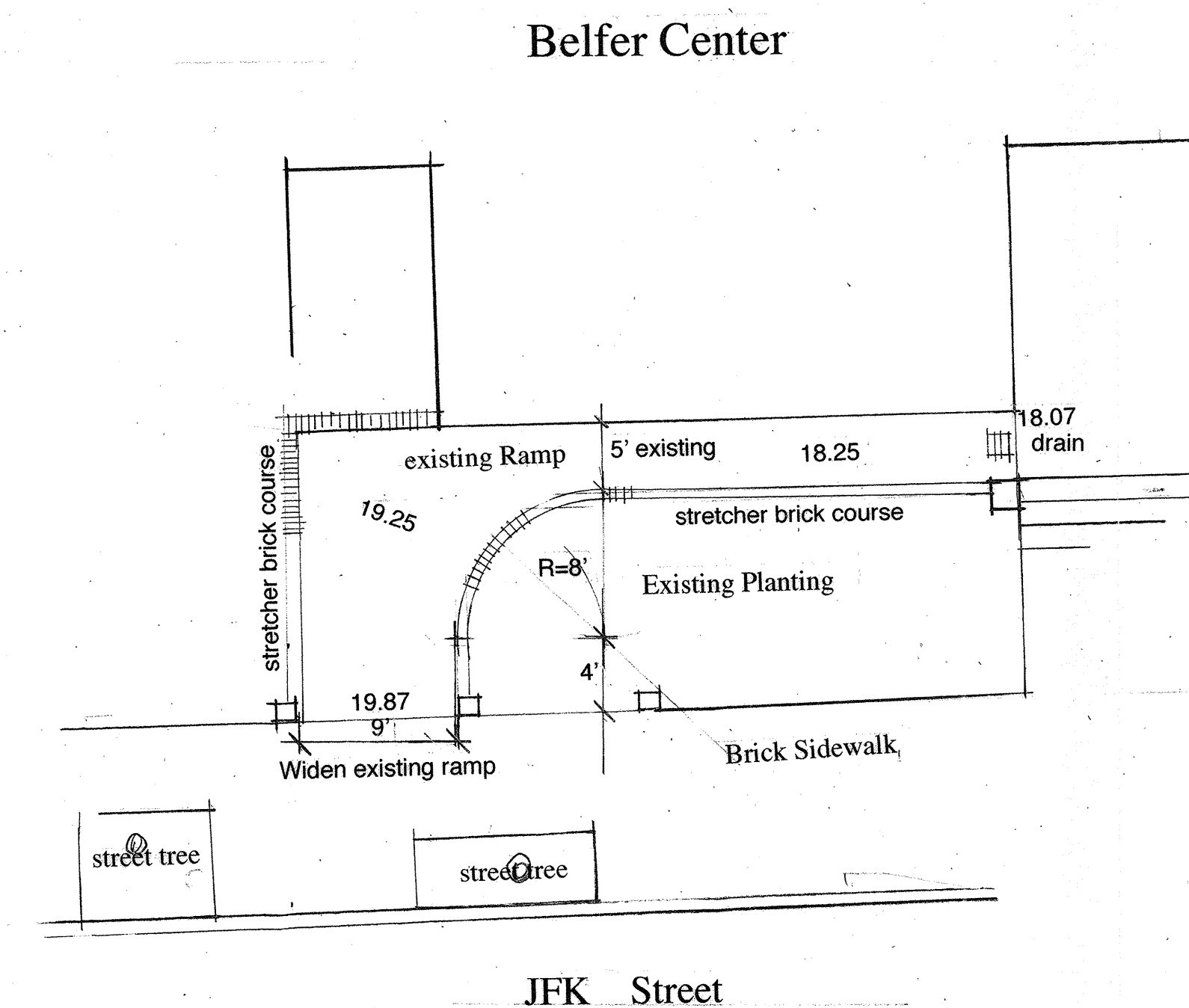

Belfer Center Handicap Ramp

No.	Date	Revision	By

RICK LAMB ASSOCIATES.
 LANDSCAPE ARCHITECTURE
 LAND PLANNING + DESIGN
 33 Athens Street, Cambridge, MA 02138
 Tel: 617-868-1939 Fax: 617-354-3387

JFK School of Government Handicap Ramps
 Plan

Littauer Center Handicap Ramp
 Belfer Center Handicap Ramp

Drawing Title

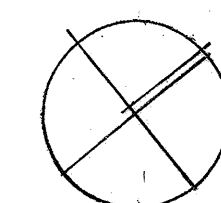

North

Stamp

Ownership and Use of Documents

Drawings and specifications, as instruments of professional service, are and shall remain the property of the Landscape Architect. These documents are not to be used, in whole or in part, for any other projects or purposes, or by any other parties, than those properly authorized by contract, without specific written authorization of Rick Lamb Associates.

Scale 1/8" = 1' 0" Drawing No.

Date
 August 8, 2008

LA 1