

FINISH NOTES:

1. WALL SURFACES BEING PREPARED FOR PAINT SHALL HAVE PAINT APPLIED IN ACCORDANCE WITH MANUFACTURER'S SPECIFICATIONS. PROVIDE A MINIMUM OF (2) COATS OVER PRIME AS REQUIRED.
2. THE PAINT SUB-CONTRACTOR SHALL SUPPLY (3) SAMPLES OF EACH FINISH FOR REVIEW AND APPROVAL. AFTER SAMPLE APPROVAL, PAINT WALL MOCKUP FOR FINAL APPROVAL.
3. PAINT ALL DRYWALL CEILINGS, BOTTOMS OF SOFFITS, EXPOSED CEILINGS, AND CEILING ABOVE MTL-1 WITH (2) COATS OF FLAT PAINT, SEE FINISH SCHEDULE FOR COLOR.
4. IF REQUIRED, CONTRACTOR TO PROVIDE ALL TEST DATA FOR MATERIALS SPECIFIED TO THE CITY BUILDING DEPARTMENT.
5. WHERE CARPETING OCCURS IN DOORWAYS, INSTALLER TO LOCATE BEAM UNDER THE CENTER OF THE DOOR (ALIGNMENT OF PATTERN IS CRITICAL).
6. CLOSETS ARE TO RECEIVE SAME FINISHES AS SPECIFIED FOR THE ROOM ONTO WHICH THEY OPEN.
7. HORIZONTAL SEAMS AT WALL COVERING AND CUTTING AT CORNERS ARE NOT ACCEPTABLE. CUTTING TO BE NOT LESS THAN 3" FROM AN INSIDE CORNER, AND NOT LESS THAN 4" FROM AN OUTSIDE CORNER U.O.N. MEET MANUFACTURER'S INSTALLATION PROCEDURES FOR WALLCOVERING AS REQ'D.
8. G.C. TO SUBMIT (3) SAMPLES PER FLOOR FINISH OF ACTUAL DIE LOT FOR REVIEW BY ARCHITECT.
9. CARPET TILES TO BE INSTALLED QUARTER TURN.
10. ANY FLOORING INSTALLED PRIOR TO OTHER TRADES BEING COMPLETE SHALL PROVIDE ADEQUATE PROTECTION FOR INSTALLED GOODS. THE SUB SHALL HAVE THE EDGES TRIMMED AND SEALED ACCORDING TO THE MANUFACTURER'S SPECIFICATIONS. ANY EDGES NOT SEALED THAT TRAVEL WILL BE REPAIRED/REPLACED AT THE SUB-CONTRACTORS EXPENSE.
11. PRIOR TO INSTALLING WOOD FLOORING GC TO ALLOW PRODUCT TO ACCLIMATE TO TEMPERATURE AND HUMIDITY OF SITE PER MANUFACTURER RECOMMENDATIONS.
12. ALL RUBBER BASE SHALL BE 1/8" ROLL GOODS, STRAIGHT ONLY AT CARPET COVED AT VCT.
13. THE MILLWORK SUB-CONTRACTOR SHALL SUBMIT SHOP DRAWINGS, HARDWARE CUTS AND FINISH SAMPLES FOR REVIEW AND APPROVAL.
14. THE GENERAL CONTRACTOR SHALL COORDINATE AND INCLUDE IN THE PAINTING SUB-CONTRACTORS PRICE TWO DAYS OF TOUCH UP AFTER THE TENANT HAS MOVED INTO THE SPACE, AFTER THE PUNCH LIST IS COMPLETE.
15. ALL ADHESIVES AND SEALANTS USED MUST NOT EXCEED THE VOC CONTENT LIMITS OF:
 - ADHESIVE, SEALANTS AND SEALANT PRIMERS: SOUTH COAST AIR QUALITY MANAGEMENT DISTRICT (SCAQMD) RULE #1108 REQUIREMENTS IN THE MOST RECENT ADDITION
 - AGRISEAL ADHESIVE: GREEN SEAL STANDARD GS-38 REQUIREMENTS IN THE MOST RECENT ADDITION
 - SEE LEED FOR COMMERCIAL INTERIORS V2009 - REFERENCE GUIDE EQ CREDIT 4.1 FOR ADDITIONAL INFORMATION
 - GC TO SUBMIT PRODUCT CUT SHEETS DOCUMENTING EACH PRODUCT STATE THE VOC LEVEL, THE APPLICATION, THE CLASSIFICATION OF MATERIALS AND THE VOC LIMIT.
16. ALL PAINTS AND COATINGS APPLIED ON SITE MUST MEET THE LIMITATIONS AND RESTRICTIONS CONCERNING CHEMICAL COMPONENTS SET BY THE FOLLOWING STANDARDS:
 - TOPCOAT PAINTS: GREEN SEAL STANDARD GS-11, PAINTS' MOST RECENT ADDITION
 - ANTI-CORROSION AND ANTI-RUST PAINTS: GREEN SEAL STANDARD GS-03, ANTI-CORROSION PAINTS' MOST RECENT ADDITION FOR APPLICATIONS ON FERROUS METAL SUBSTRATES
 - ALL OTHER ARCHITECTURAL COATINGS, PRIMERS AND UNDERCOATS: SOUTH COAST AIR QUALITY MANAGEMENT DISTRICT (SCAQMD) RULE 1113, ARCHITECTURAL COATINGS' MOST RECENT ADDITION
 - SEE LEED FOR COMMERCIAL INTERIORS V2009 - REFERENCE GUIDE EQ CREDIT 4.2 FOR ADDITIONAL INFORMATION
17. ALL CARPET INSTALLED ON SITE MUST MEET OR EXCEED CARPET AND RUG INSTITUTES GREEN LABEL PLUS TESTING AND PRODUCT REQUIREMENTS. (GREEN LABEL PLUS DOES NOT ADDRESS BACKER OR ADHESIVE.) CARPET PAD MUST MEET OR EXCEED OR GREEN LABEL TESTING AND PRODUCT REQUIREMENTS. CARPET ADHESIVES MUST MEET THE REQUIREMENTS STATED IN NOTES ABOVE.
 - SEE LEED FOR COMMERCIAL INTERIORS V2009 - REFERENCE GUIDE EQ CREDIT 4.3 FOR ADDITIONAL INFORMATION
 - GC TO SUBMIT PRODUCT CUT SHEETS DOCUMENTING EACH PRODUCT MEETS OR EXCEEDS THE APPLICABLE TESTING AND PRODUCT REQUIREMENTS.
18. ALL COMPOSITE WOOD AND AGRIFIBER PRODUCTS, INCLUDING DOOR MATERIALS, MUST CONTAIN NO ADDED UREA-FORMALDEHYDE RESINS. LAMINATED ADHESIVES USED TO FABRICATE ON-SITE AND SHOP APPLIED ASSEMBLIES CONTAINING THESE LAMINATED ADHESIVES MUST NO ADDED UREA-FORMALDEHYDE.
 - SEE LEED FOR COMMERCIAL INTERIORS V2009 - REFERENCE GUIDE EQ CREDIT 4.4 FOR ADDITIONAL INFORMATION
 - GC TO SUBMIT PRODUCT CUT SHEETS DOCUMENTING EACH PRODUCT CONTAINS NO ADDED UREA-FORMALDEHYDE RESINS AND LISTING ALL THE LAMINATING ADHESIVES USED IN THE TRIMM AND SPACE AND STATING THAT THE CONTAIN NO ADDED UREA-FORMALDEHYDE. ALSO PROVIDE DOCUMENTATION THAT ALL CORE LAMINATE ADHESIVE PRODUCTS USED ON THE PROJECT CONTAIN NO ADDED UREA-FORMALDEHYDE.
19. GC TO SUBMIT PRODUCT CUT SHEETS DOCUMENTING THE POST & PRE CONSUMER RECYCLABLE CONTENT FOR ALL APPLICABLE PRODUCTS.
20. GC TO SUBMIT PRODUCT CUT SHEETS DOCUMENTING THE PERCENTAGE FOR RAPIDLY RENEWABLE MATERIAL FOR ALL APPLICABLE PRODUCTS.
21. GC TO SUBMIT PRODUCT CUT SHEETS DOCUMENTING THAT NEW WOOD BASED PRODUCTS ARE CERTIFIED IN ACCORDANCE WITH THE FOREST STEWARDSHIP COUNCIL'S PRINCIPLES AND CRITERIA.

FINISH LEGEND:

- CPT-1 MANUFACTURER: 24"x24" CARPET TILE
SHAW CONTRACT
STYLE: CLEAR S6554
COLOR: PORCELAIN 62103
BACKING: ECOWORK
INSTALLATION METHOD: ASHLAR
- VCT-1 MANUFACTURER: 12"x12" VINYL COMPOSITION TILE
MANNINGTON
STYLE: BRUSHWORKS
COLOR: GESSO WHITE #711
INSTALLATION METHOD: MONOLITHIC
- VB-1 MANUFACTURER: 4" VINYL WALL BASE
JOHNSONITE
STYLE: VINYL WALL BASE
COLOR: #63 BURNT LUMBER STRAIGHT
- VB-2 MANUFACTURER: 4" VINYL WALL BASE
JOHNSONITE
STYLE: VINYL WALL BASE
COLOR: #40 BLACK COVE

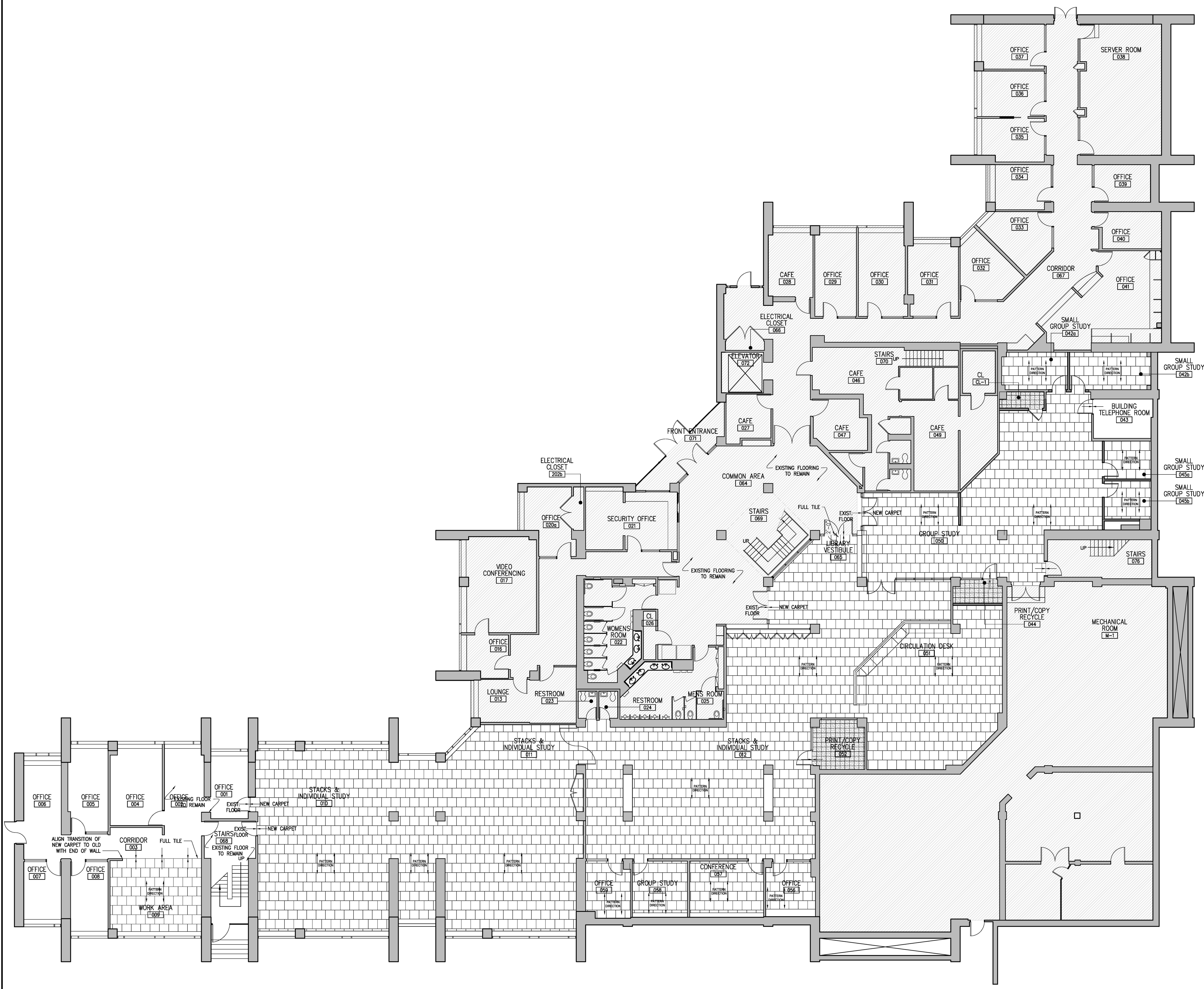

BAKER DESIGN GROUP INC.

DESIGN INTEGRATION

23 DRYDOCK AVENUE, SIXTH FLOOR
BOSTON, MASSACHUSETTS 02210 USA
TEL: 617.338.8870
FAX: 617.338.8876

www.bdg-inc.com

Architects / Engineer's Stamp

Date	Description

25 November 2009 Issued for Construction

Drawing North:	Drawing Scale: 1/8" = 1'-0"
	Job Number: 20914
	Drawn By: ksd

Finish Plan and Notes