

**BELFER CENTER
KENNEDY SCHOOL OF
GOVERNMENT
HARVARD UNIVERSITY**

SCALE: 1/4"=1'-0"
JOB NO: 602
DRAWN: P.L.
DATE: 9/27/82
REVISIONS:
△ 10/2/82
△ 5/21/83

FIRST FLOOR
RECESSED CEILING
PLAN

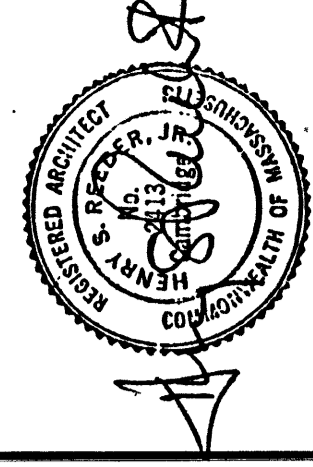

**ARCHITECTURAL
RESOURCES
CAMBRIDGE INC**
102 MOUNT AUBURN ST
CAMBRIDGE MA 02138
TEL: (617) 547-2200

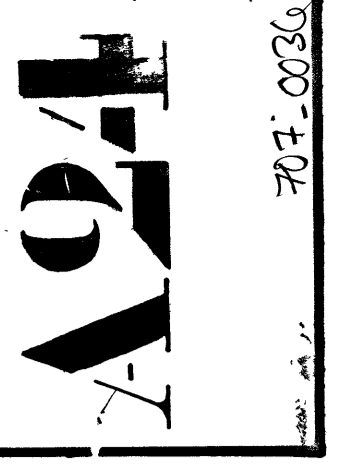

14 13 12 11 10 9 8 7 6 5 4 3 2 1

N
M
K
J
I
H
G
F
E
D
C
B
A
X
W

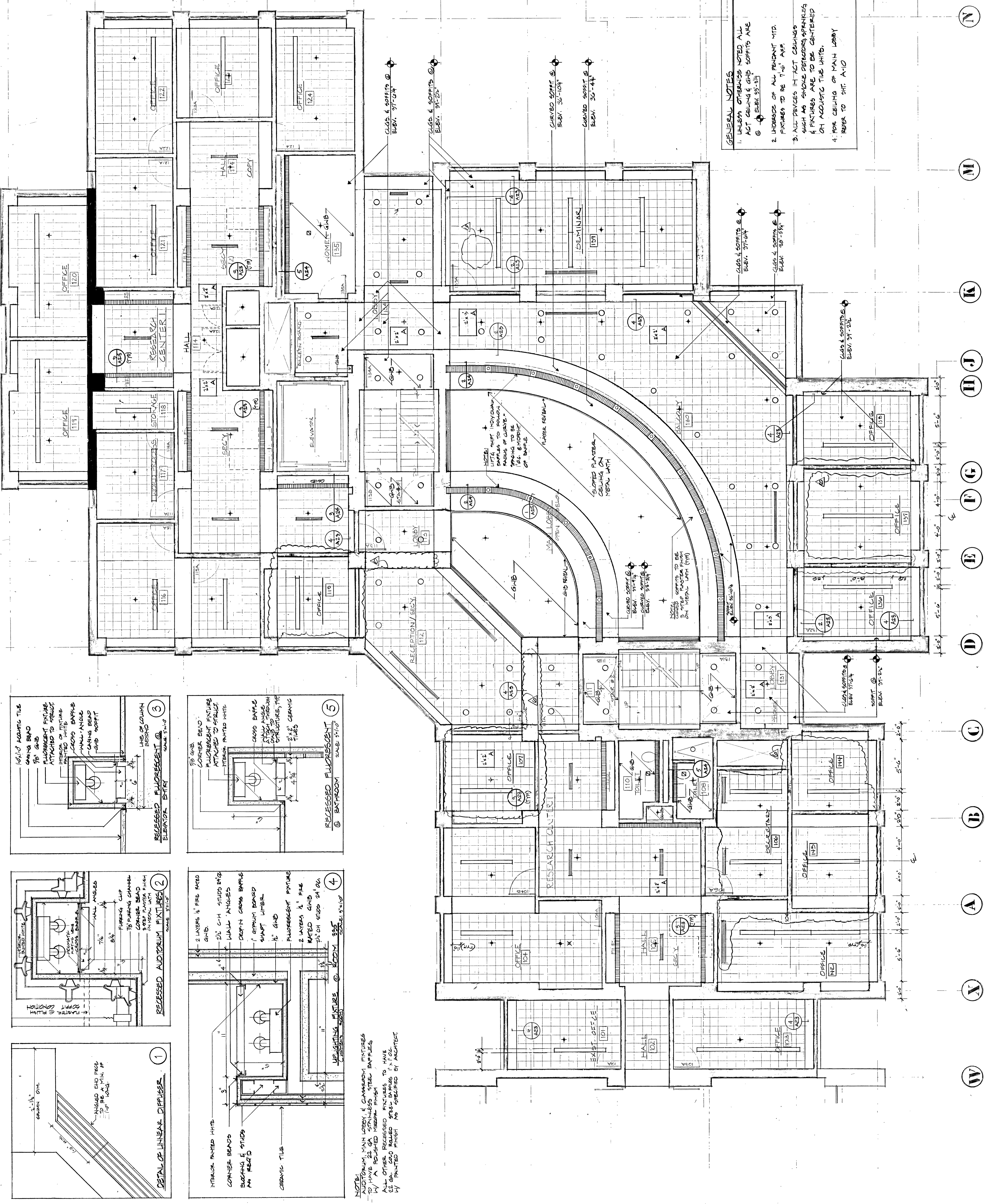

GENERAL NOTES
1. UNLESS OTHERWISE NOTED ALL ACT CEILING & GIB SOPSITS ARE @ ELEV. 93'-0"
2. UNLESS OTHERWISE NOTED ALL ACT CEILING & GIB SOPSITS ARE @ ELEV. 93'-0"
3. UNLESS OTHERWISE NOTED ALL ACT CEILING & GIB SOPSITS ARE @ ELEV. 93'-0"
4. UNLESS OTHERWISE NOTED ALL ACT CEILING & GIB SOPSITS ARE @ ELEV. 93'-0"

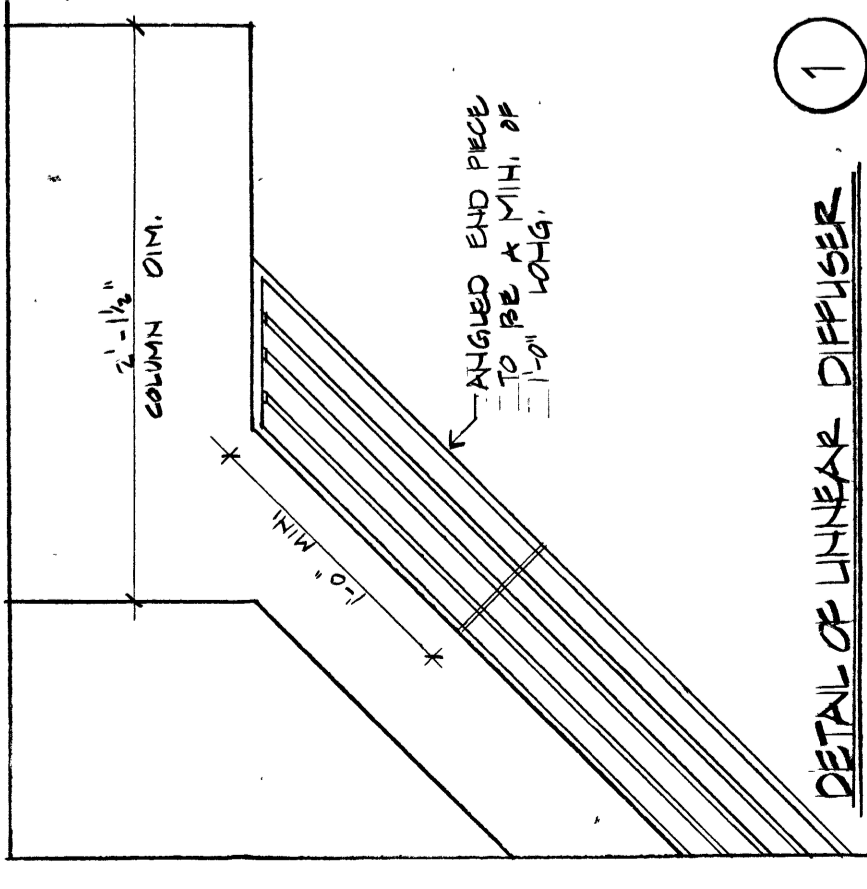
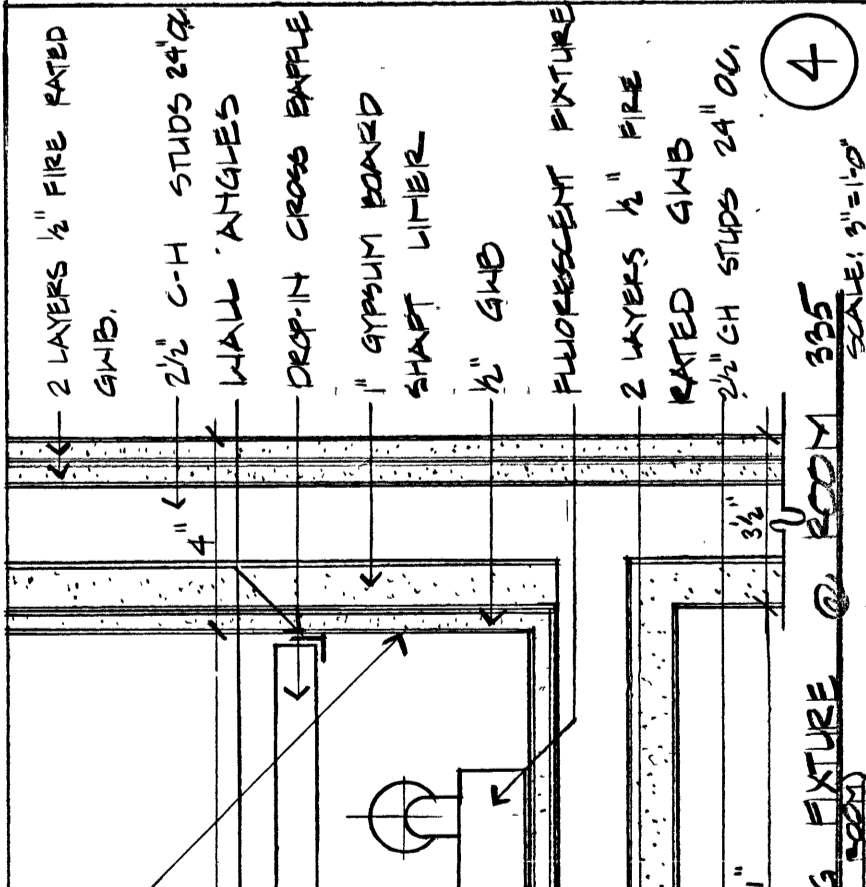
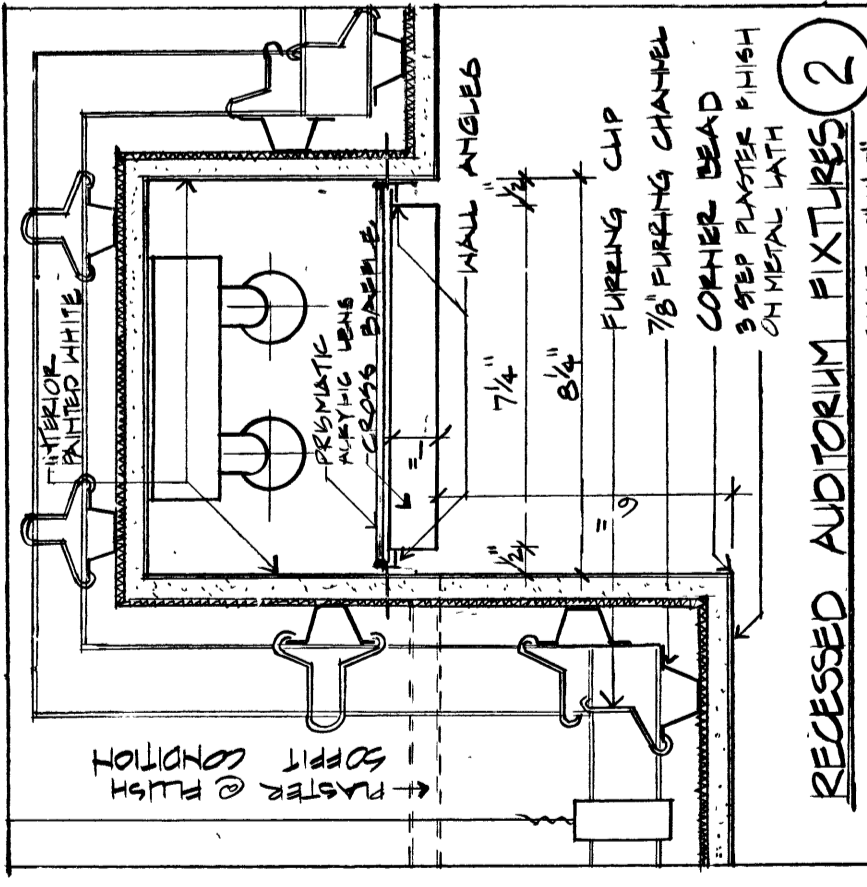
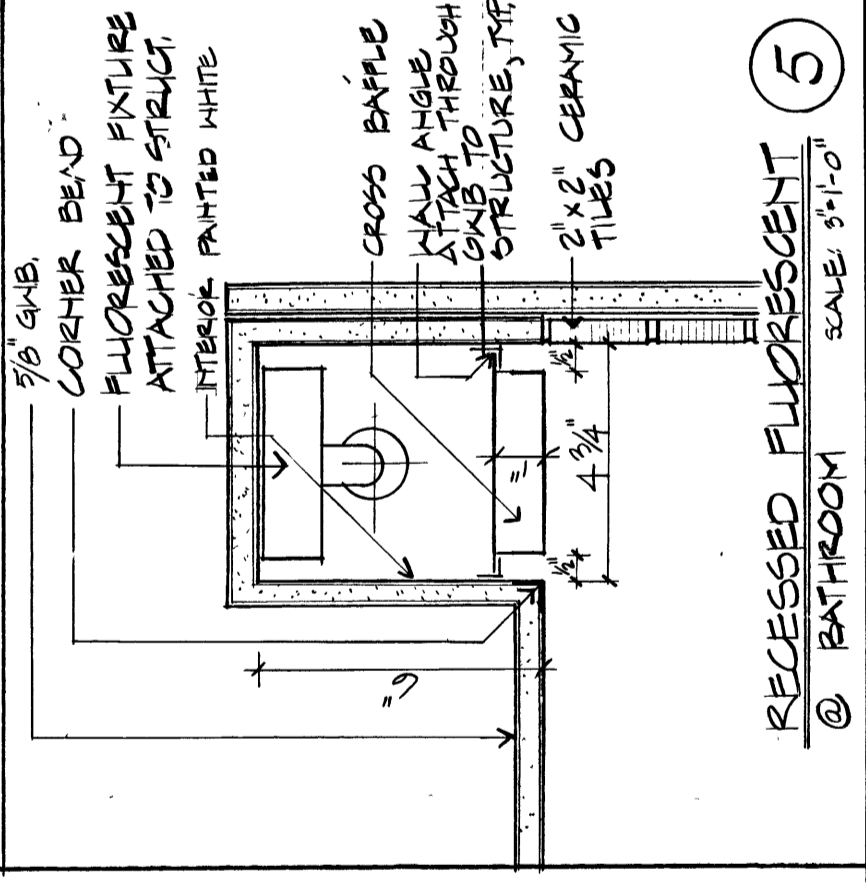
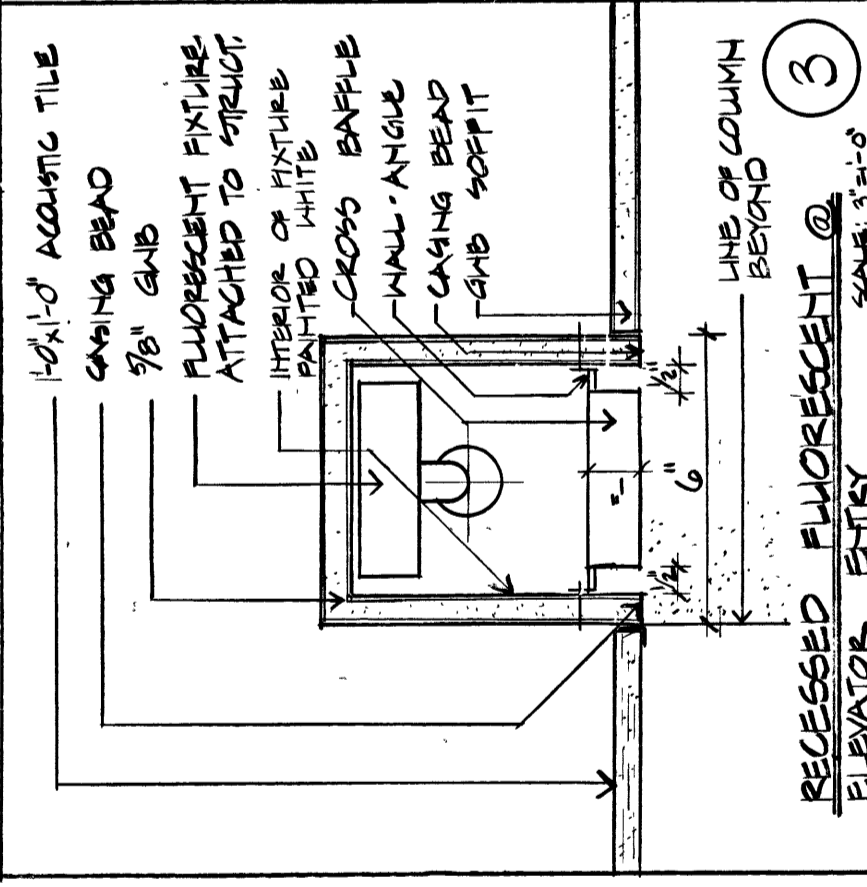

NOTE: AUDITORIUM MAIN LOBBY & CLASSROOM FIXTURES TO HAVE 22 GA STAINLESS STEEL BARRIES TO HAVE A ROUNDED CORNER FINISH TO HAVE ALL OTHER ROOMS FINISH TO HAVE 1/2" O.D. RECESSED SPRING SPRINGS TO HAVE 1/2" PAINTED FINISH NO SPECIFIED BY ARCHITECT