

**BELFER CENTER  
KENNEDY SCHOOL of  
GOVERNMENT  
HARVARD UNIVERSITY**

SCALE: 1/4"=1'-0"  
JOB NO: 8102  
DRAWN: P.L.L.  
DATE: 9/27/82

REVISIONS:  
△ 10/1/82  
△ 5/17/83

THIRD FLOOR  
REFLECTED CEILING  
PLAN

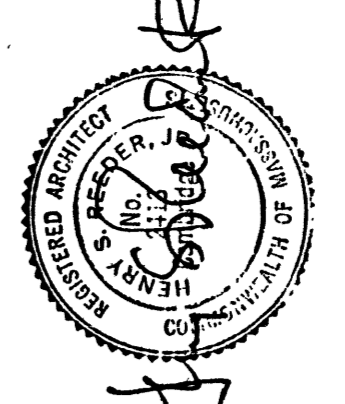

**ARCHITECTURAL  
RESOURCES INC  
CAMBRIDGE INC**  
102 MOUNT AUBURN ST  
CAMBRIDGE MA 02138  
TEL: (617) 547-2200

**A26**  
7-17-0028

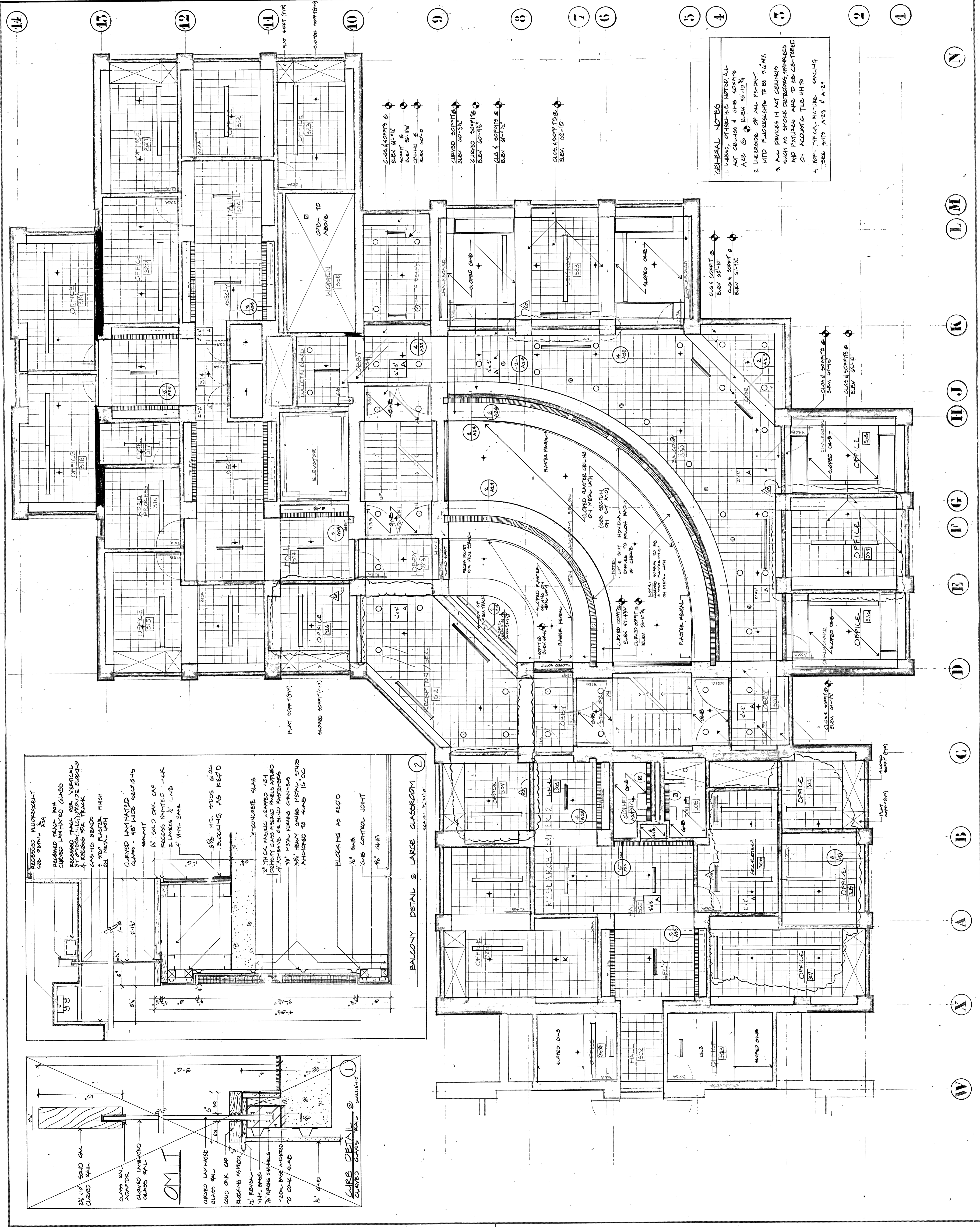

**GENERAL NOTES**

1. ALLERS OTHERS LIKE NOTED ALL ACT CHANGES & GNB SCHEDULES ARE @ ELEV. 62'-10 3/4"
2. UPGRADE OF ALL PENDANT & MTD FLUORESCENTS TO BE TIGHT
3. ALL DEVICES IN ACT CEILING SUCH AS SMOKE DETECTORS, SPRINKERS AND FIXTURES ARE TO BE CENTERED ON ACoustic TILE UNITS
4. TYPICAL FUTURE SPACING - SEE SHTS A-23 & A-24

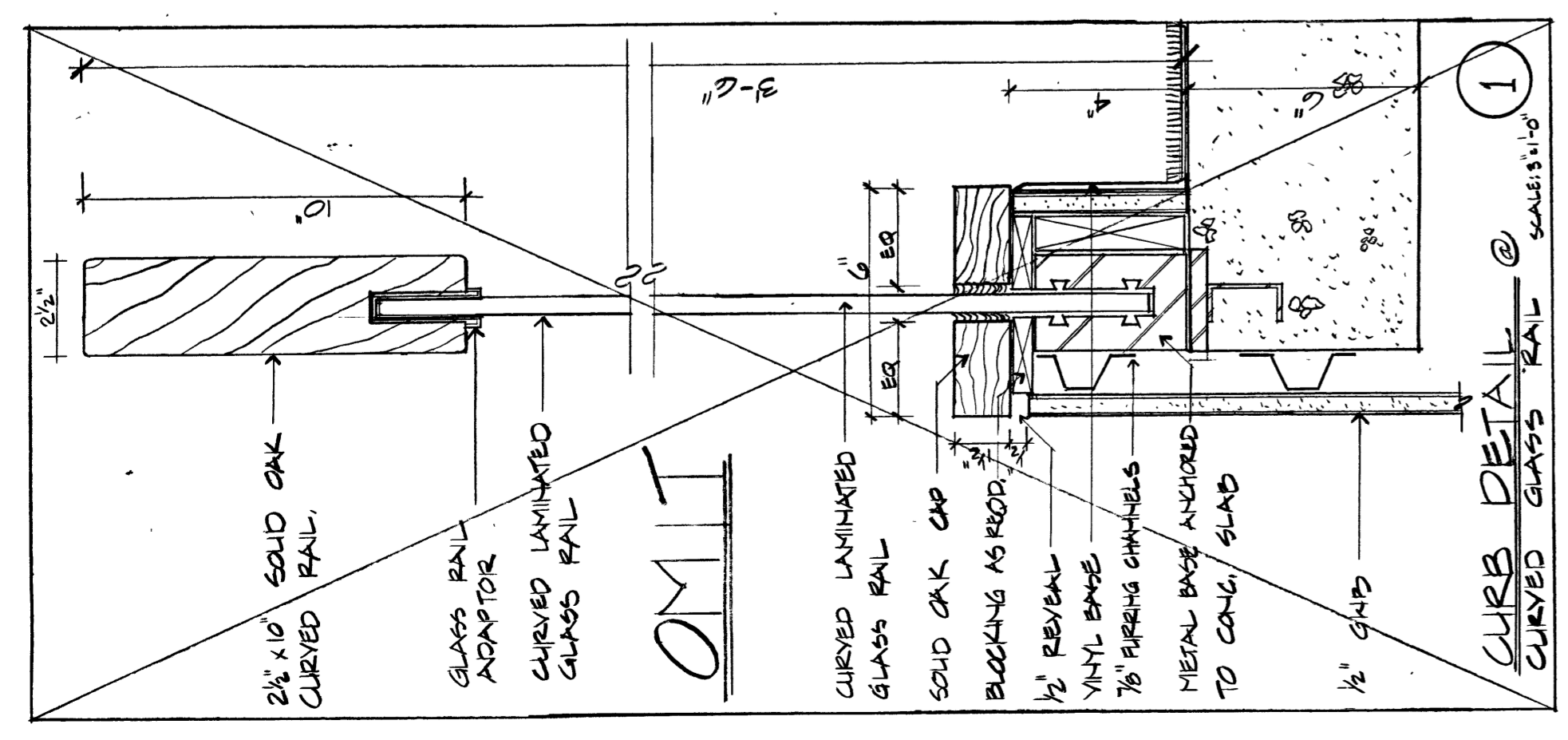
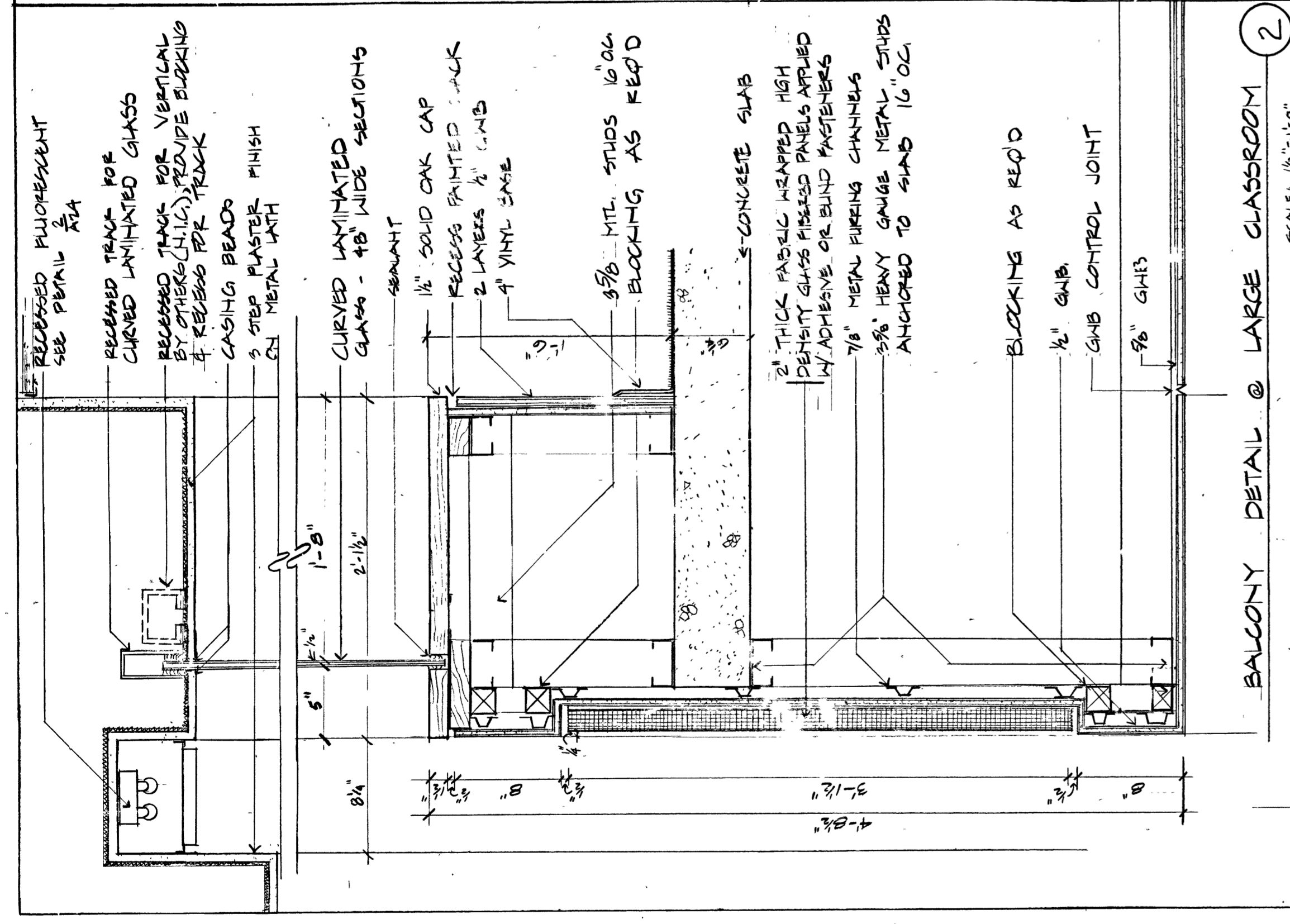

N  
M  
L  
K  
J  
H  
G  
F  
E  
D  
C  
B  
A  
X  
W

14  
15  
12  
11  
10  
9  
8  
7  
6  
5  
4  
3  
2  
1