

BELFER CENTER
KENNEDY SCHOOL of GOVERNMENT
HARVARD UNIVERSITY

SCALE: 1/4" = 1'-0"
 JOB NO: 002
 DRAWN: PLL
 DATE: 01/27/02

REVISIONS:
 Δ 12/14/02
 Δ 1/14/02
 Δ 12/1/02
 Δ 5/21/03

FIFTH FLOOR
 REFLECTED CEILING
 PLAN

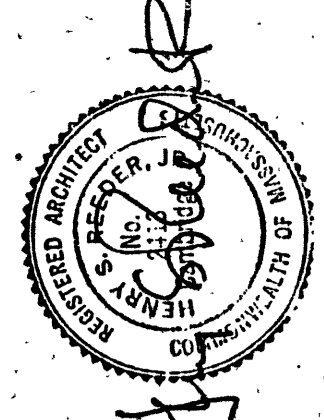

ARCHITECTURAL RESOURCES CAMBRIDGE INC
 102 MOUNT AUBURN ST
 CAMBRIDGE MA 02138
 TEL: (617) 547-2200

A98

707-00190

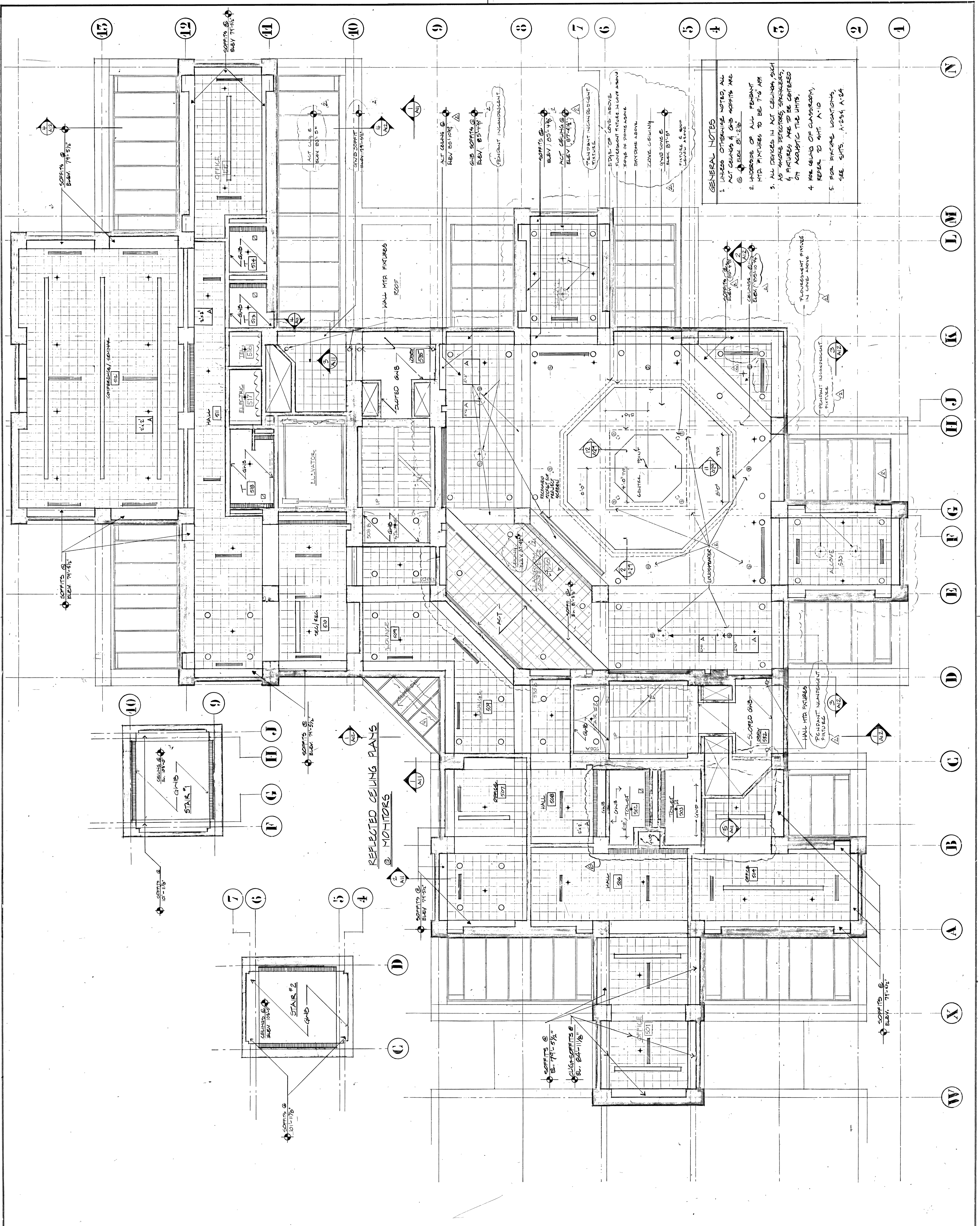

GENERAL NOTES

1. UNLESS OTHERWISE NOTED, ALL ACT CEILING & GIB SOFFITS ARE @ ELEV. 8'-2 1/2"
2. HORIZES OF ALL PENDANT MTD FIXTURES TO BE 7'-6" AFF
3. ALL DEVICES IN ACT CEILING SUCH AS SMOKE DETECTORS, SPRINKLERS, & FIXTURES ARE TO BE CENTERED ON ACUSTIC TILE UNITS.
4. ROW BEING OF CLASSROOM, REFER TO SHEET A-10
5. FOR FIXTURE LOCATIONS, SEE SPTS. A-204, A-24

REFLECTED CEILING PLAN
 @ MONITORS

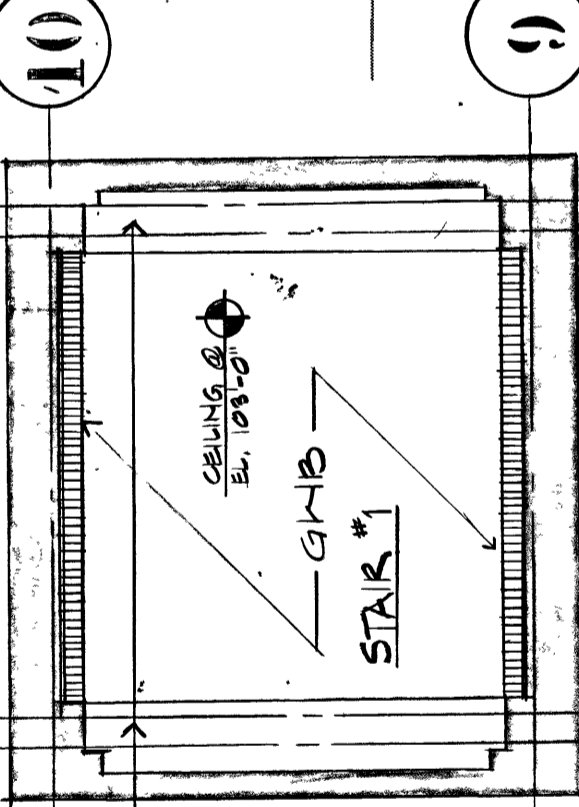
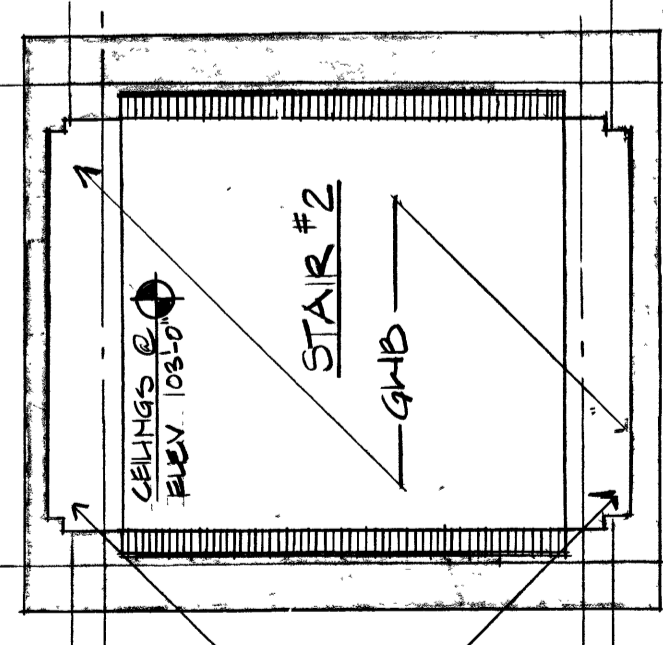

N
M
L
K
J
I
H
G
F
E
D
C
B
A
X
W

17

12

11

10

9

8

7

6

5

4

3

2

1

7

6

5

4

3

C

D

F

G

H

J

10

9

10

W

X

A

B

C

D

E

F

G

H

J

K

L

M

N

CAMTIT