

SECTION A-A VENT PIPE CROSSING
SCALE: 1" = 5'

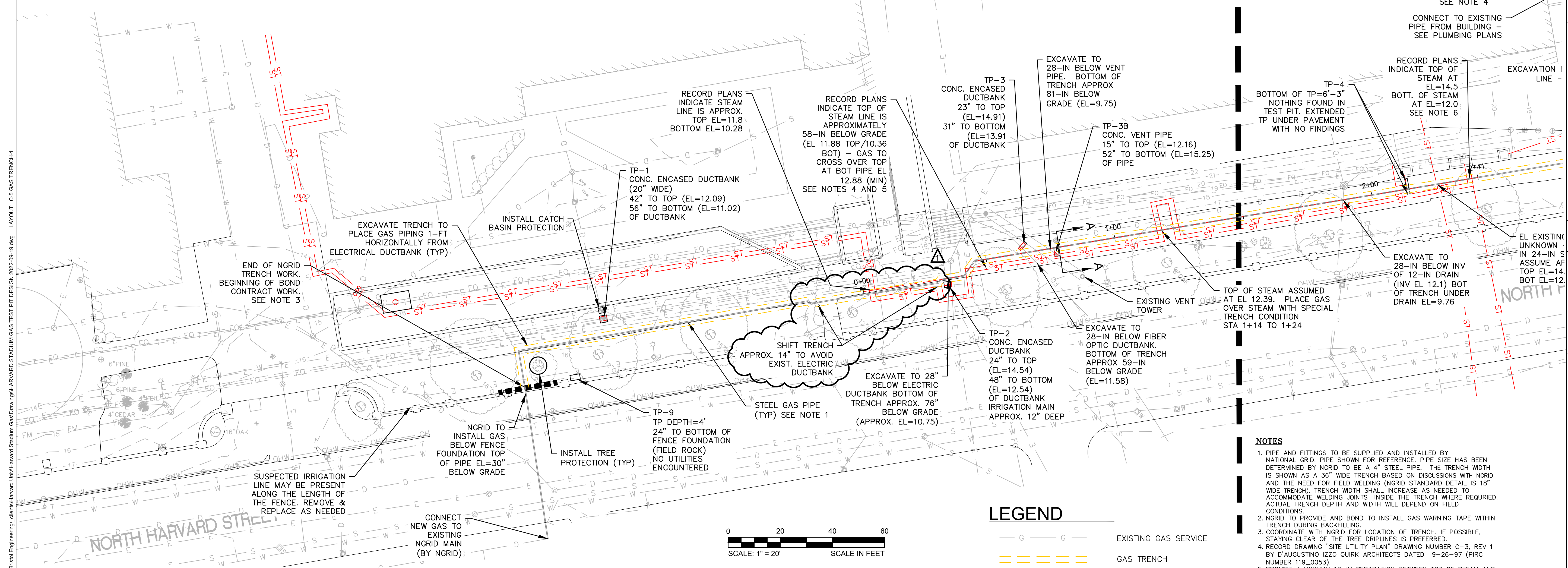

LEGEND

- EXISTING GAS SERVICE
- GAS TRENCH

- NOTES**
- PIPE AND FITTINGS TO BE SUPPLIED AND INSTALLED BY NATIONAL GRID. PIPE SHOWN FOR REFERENCE. PIPE SIZE HAS BEEN DETERMINED BY NGRID TO BE A 4" STEEL PIPE. THE TRENCH WIDTH IS SHOWN AS A 36" WIDE TRENCH BASED ON DISCUSSIONS WITH NGRID AND THE NEED FOR FIELD WELDING (NGRID STANDARD DETAIL IS 18" WIDE TRENCH). TRENCH WIDTH SHALL INCREASE AS NEEDED TO ACCOMMODATE WELDING JOINTS INSIDE THE TRENCH WHERE REQUIRED. ACTUAL TRENCH DEPTH AND WIDTH WILL DEPEND ON FIELD CONDITIONS.
 - NGRID TO PROVIDE AND BOND TO INSTALL GAS WARNING TAPE WITHIN TRENCH DURING BACKFILLING.
 - COORDINATE WITH NGRID FOR LOCATION OF TRENCH, IF POSSIBLE, STAYING CLEAR OF THE TREE DRILPLINES IS PREFERRED.
 - RECORD DRAWING "SITE UTILITY PLAN" DRAWING NUMBER C-3, REV 1 BY D'AUGUSTINO IZZO QUIRK ARCHITECTS DATED 9-28-97 (PIRC NUMBER 119_0053).
 - PROVIDE A MINIMUM 12-IN SEPARATION BETWEEN TOP OF STEAM AND BOTTOM OF GAS. 18-IN SEPARATION IS PREFERRED IF SPACE ALLOWS.
 - RECORD DRAWING "PHASE ONE SITE UTILITIES HEATING DETAILS" DRAWING NUMBER 2.32 BY TAC DATED 4-28-1976. (PIRC NUMBER 862_0027). ACCORDING TO THE PLAN, THE STEAM IS SLOPED FROM STEAM MANHOLE AT BLODGETT TO ENTRANCE ON THE WEST SIDE OF MURR.

PROJECT NO.	NO.	DESCRIPTION	DATE
XX	1	RESPONSE TO RFI #1 & #2	01/10/24
RDC		FINAL CONSTRUCTION SET	01/08/24
TAT		CONFORMED SET: TRENCH WIDTH, BOLLARDS, CONC. PAD AT RINK	06/16/23

HARVARD UNIVERSITY
HARVARD ATHLETICS AREA GAS MAIN PROJECT
GAS TRENCH PLAN-1

CAD FILE: C:\Users\Ryan.Chase\Documents\Bristol\Engineering\clients\Harvard_University\Harvard Stadium Gas\Drawings\HARVARD STADIUM GAS TEST PIT DESIGN 2022.06.19.dwg LAYOUT: C-5 GAS TRENCH-1