

KENNEDY SCHOOL OF GOVERNMENT

HARVARD UNIVERSITY

CENTER FOR BUSINESS AND GOVERNMENT RENOVATION

SCALE: AS NOTED
JOB NO: 0035
DRAWN: S.F./S.M.
DATE: SEPTEMBER 28, 2000
FILE NAME: A1-1
REVISIONS:

BELFER FIFTH FLOOR DEMO/CONST. AND RCP

ARCHITECTURAL RESOURCES CAMBRIDGE INC
140 MOUNT AUBURN ST
CAMBRIDGE MA 02138
TEL. (617) 547-2200
FAX. (617) 547-7222

A1-1

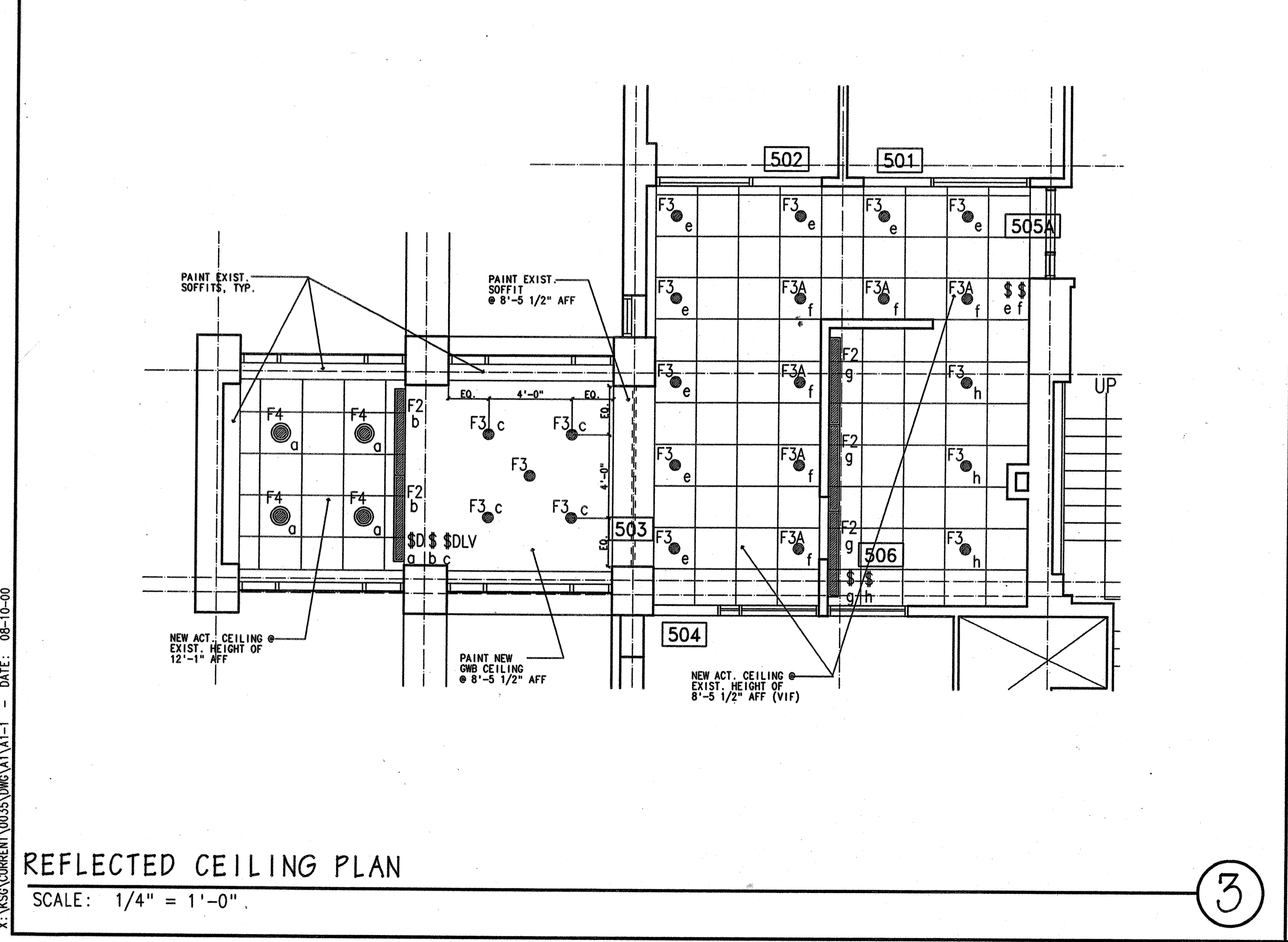
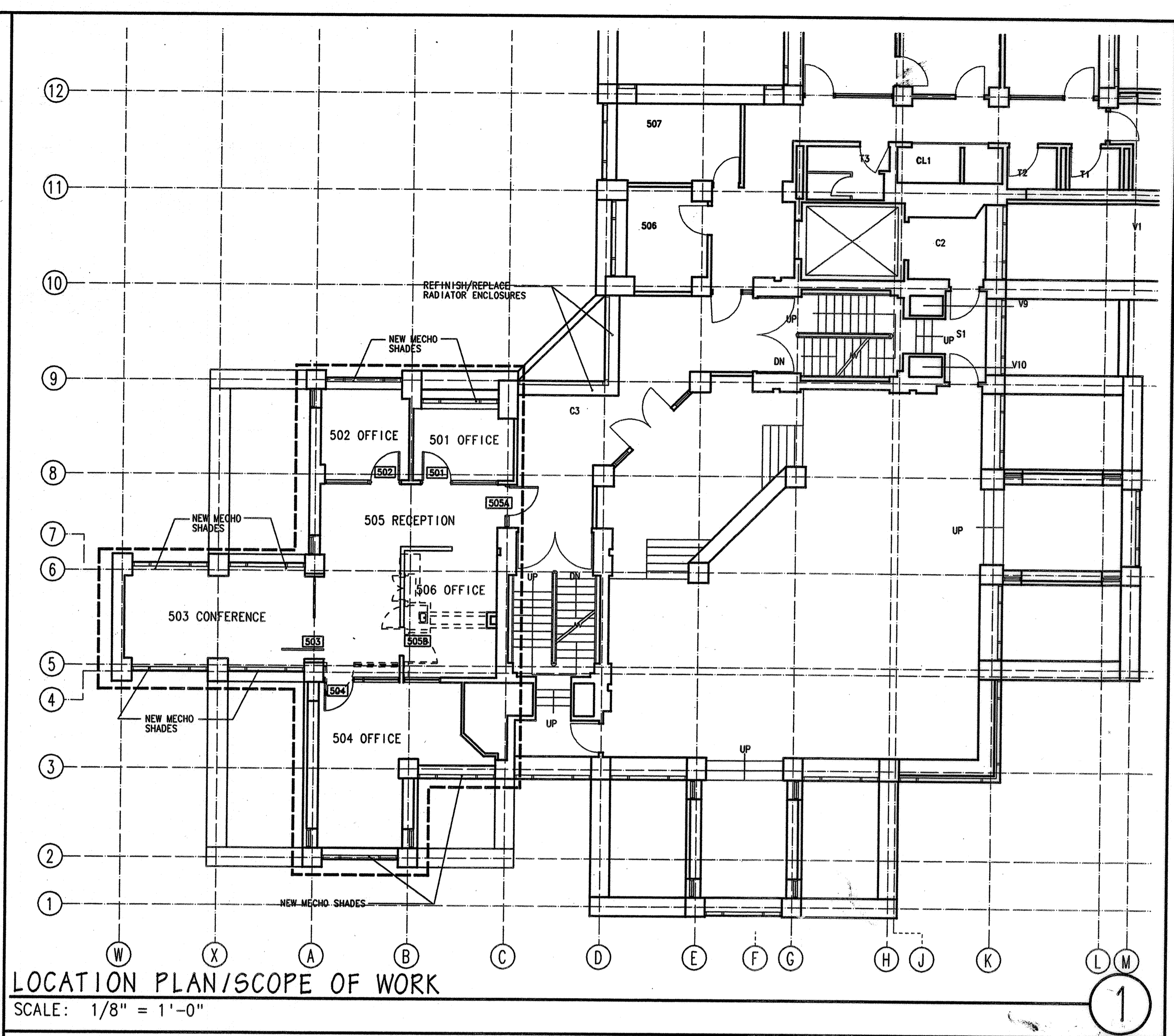
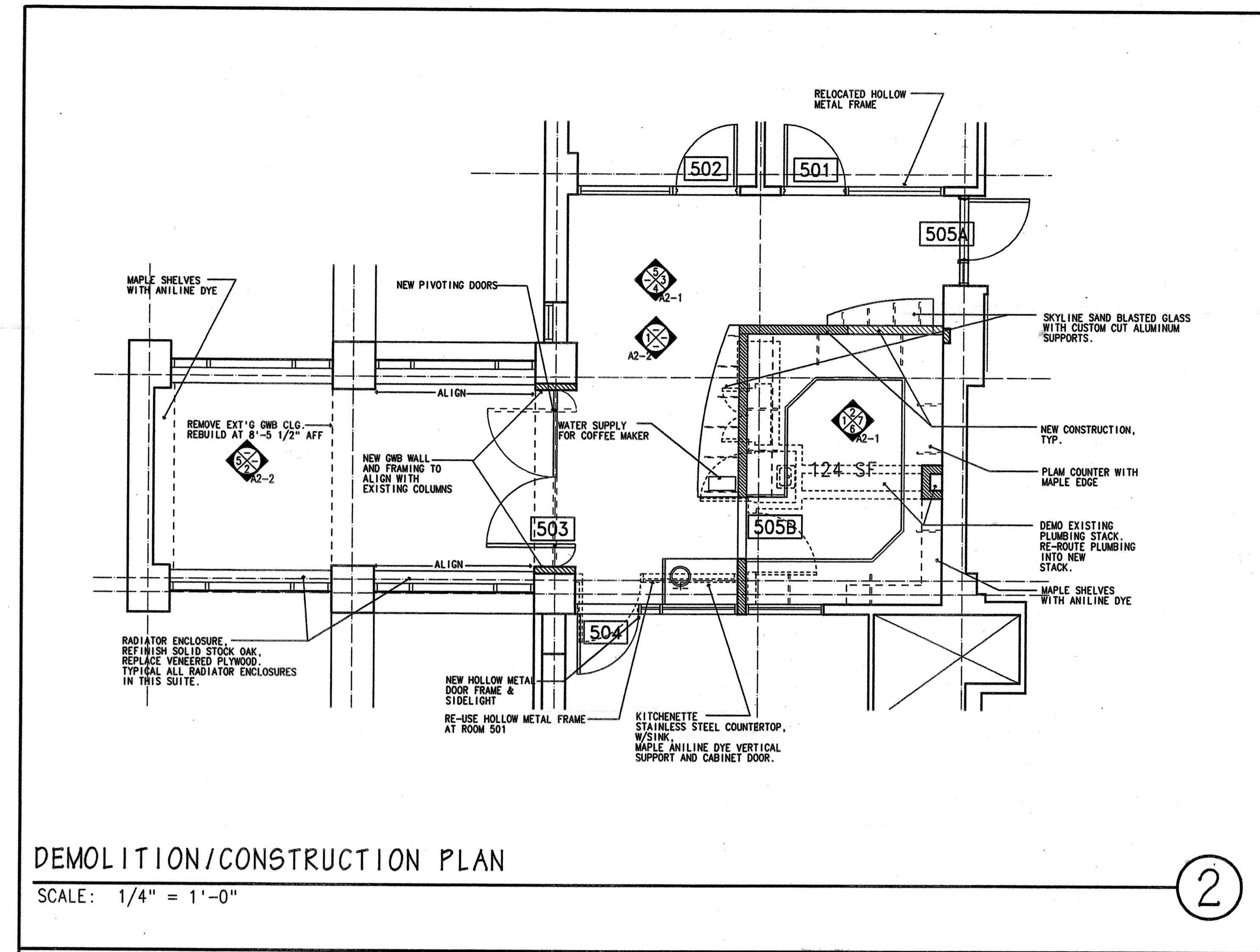

SYMBOL LIST

F2 = 49-3/4"	NEORAY SHELL SERIES 201 III/2TB ELECTRONIC BALLAST ROUND HOLE PERFORATED PATTERN 277V F32TB/SP30	F4	LIGHTOLIER 6-3/4" STANDARD IC CAN STANDARD 1102P1, REMODELER 1900P1 (AS REQ'D) 1105 MATTE BLACK STEP BAFFLE 100PAR38/HR/FL40"
F3	LIGHTOLIER LYTECASTER LOW VOLTAGE CAN - STANDARD NON-IC 1102P1 TRIM - 1152 6-3/4" PINHOLE REFLECTOR WITH MATTE WHITE FACEPLATE LAMP - Q50MR16/C/EXN	\$D	LUTRON #NT-600-WH
F3A	SIMILAR LAMP - Q50MR16/C/EXT	\$DLW	LUTRON #NTLV-600-WH
		\$	LUTRON #NT-IP-S-WH

- FINISH NOTES
- ROOMS 501, 502, 503, 504, 505 & 506 AND MAIN CORRIDOR SHALL RECEIVE NEW CARPET, SEE SPEC
 - UNLESS OTHERWISE NOTED, REPAINT ALL EXISTING AND NEW WALLS IN THE FOLLOWING ROOMS: 501, 502, 503, 504, 505 & 506. REPAINT ALL WALLS WHERE NEW CARPET IS INSTALLED.
 - PAINT NEW & EXISTING HM DOOR FRAMES @ 501, 502, 504, & 505A
 - INSTALL NEW RUBBER BASE AT ALL NEW CARPET LOCATIONS.
 - PAINT ALL NEW & EXISTING GWB CEILINGS & SOFFITS.
 - ACCENT WALLS LOCATED IN ROOMS 503 & 505, ARCHITECT SHALL SELECT COLOR.

X:\KSG\CURRENT\0035\DWG\A1\A1-1 - DATE: 08-10-00

707-5022